



27 Larkspur Croft, Boston, PE21 8EF
£120,000

27 Larkspur Croft, Boston, PE21 8EF

A well-proportioned family home offered for sale with a tenant in situ, presenting an ideal opportunity for investors. The property is maintained to a good standard throughout and offers practical living accommodation. Externally, the home benefits from a private garden, driveway parking and a garage. Conveniently laid out and suited to long-term rental demand, this is a straightforward investment purchase.







Ground Floor

Approx. 22.8 sq. metres (245.2 sq. feet)

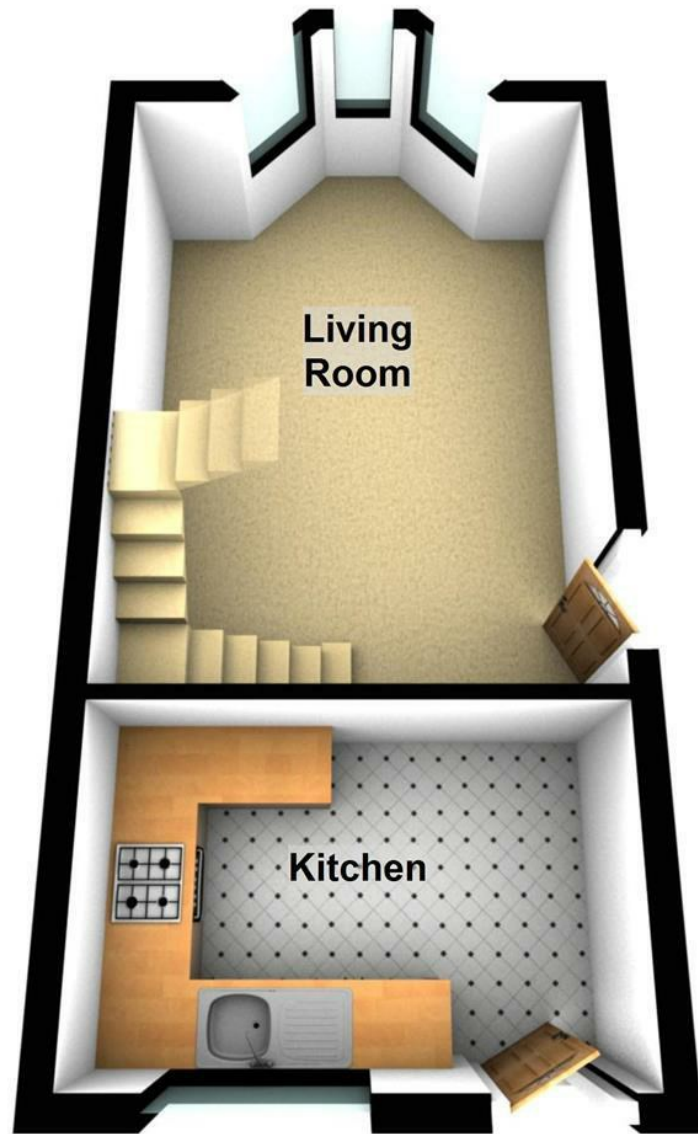

First Floor

Approx. 20.8 sq. metres (224.0 sq. feet)



Total area: approx. 43.6 sq. metres (469.2 sq. feet)